



DATI TECNICI / TECHNICAL DATA

| | | | |
|---|--------------------------------|---------------------|-----------------------|
| Fluido / Fluid | Aria / Air | | |
| Pressione Max / Maximum pressure | 15 bar | | |
| Temperatura / Temperature | -10 / +50° C | | |
| Grado di filtrazione / Filtration grade | 5 - 20 - 50µm | | |
| Portata a 6 bar con Δp 1bar / 6bar flow rate with Δp 1bar | 1=2600 NI/min | 2=5600NI/min | 3=8200NI/min |
| Capacità tazza / Bowl capacity | 1=22cm ³ | 2=46cm ³ | 3=89,5cm ³ |
| Viti per fissaggio / Wall clamping screws | 1=M4X14 | 2=M5X18 | 3=M6X20 |
| Olio consigliato / Recommended oil | Classe ISO 22 a Norma ISO 3448 | | |

PRODOTTI STANDARD / STANDARD PRODUCTS

| codice code | taglia size | filetto thread | portata flow rate | carico olio oil load |
|----------------|----------------|-------------------|----------------------|-------------------------|
| XL1210 | 1 | 1/4 | 2600NI/min | M |
| XL1310 | 1 | 3/8 | 2600NI/min | M |
| XL1320 | 1 | 3/8 | 2600NI/min | A |
| XL2310 | 2 | 3/8 | 5600NI/min | M |
| XL2410 | 2 | 1/2 | 5600NI/min | M |
| XL2420 | 2 | 1/2 | 5600NI/min | A |
| XL3510 | 3 | 3/4 | 8200NI/min | M |
| XL3610 | 3 | 1" | 8200NI/min | M |
| XL3620 | 3 | 1" | 8200NI/min | A |
| XL3630 | 3 | 1" | 8200NI/min | M2L |

M: Manuale / Manual
A: Automatico a depressione / Automatic to vacuum-operated
M2L: Manuale con sensore a due livelli / Two steps sensor Manual

CHIAVE DI CODIFICA / ORDERING CODE

XL 0 0 0 0

TAGLIA / SIZE
1=TAGLIA 1 / SIZE 1
2=TAGLIA 2 / SIZE 2
3=TAGLIA 3 / SIZE 3

FILETTO / THREAD
1=G 1/8 (TAGLIA 1)
2=G 1/4 (TAGLIA 1)
3=G 3/8 (TAGLIA 1)

2=G 1/4 (TAGLIA 2)
3=G 3/8 (TAGLIA 2)
4=G 1/2 (TAGLIA 2)

4=G 1/2 (TAGLIA 3)
5=G 3/4 (TAGLIA 3)
6=G 1" (TAGLIA 3)

0=GRUPPO SENZA TERMINALI
WITHOUT END UNITS

CARICAMENTO OLIO / OIL LOADING SYSTEM

1= MANUALE / MANUAL
2= AUTOMATICO A DEPRESSIONE /
AUTOMATIC TO VACUUM OPERATED
3= MANUALE CON SENSORE A DUE LIVELLI /
TWO STEPS SENSOR MANUALE

CARATTERISTICHE DI FLUSSO / FLOW CHARACTERISTICS

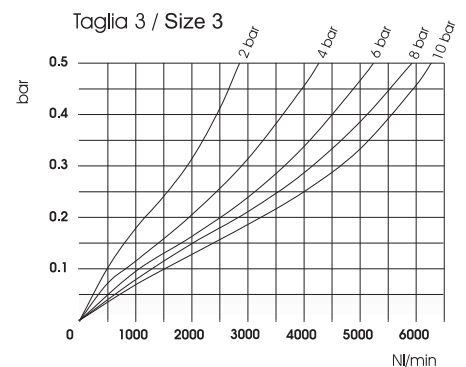
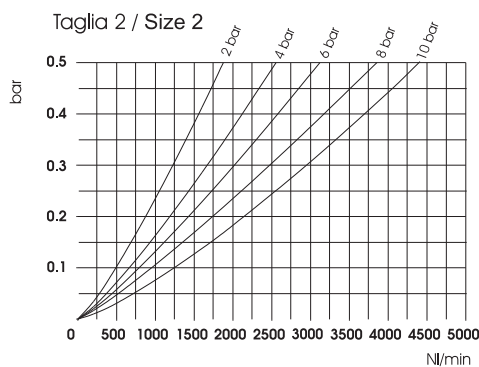
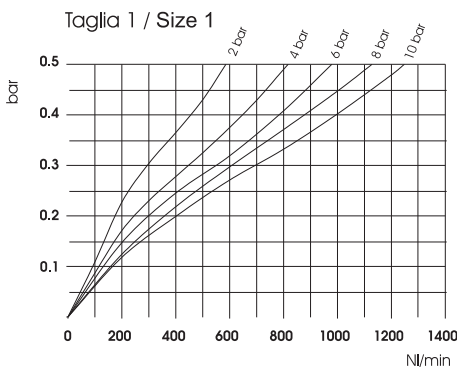

COMPONENTI / COMPONENTS

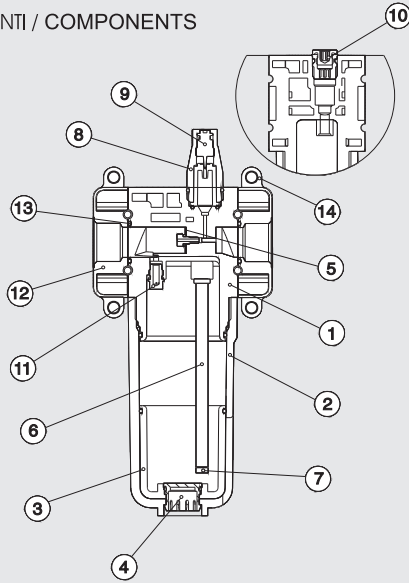

| | | |
|----|-------------------------------------|-------------------------------|
| 1 | corpo / body | tecnopolimero / technopolymer |
| 2 | tazza / bowl | tecnopolimero / technopolymer |
| 3 | bicchiere / glass | tecnopolimero / technopolymer |
| 4 | tappo / plug | tecnopolimero / technopolymer |
| 5 | membrana / membrane | |
| 6 | tubo / tube | PA11 |
| 7 | filtrino / small filter | |
| 8 | cupola / dome | tecnopolimero / technopolymer |
| 9 | spillo / pin | ottone / brass |
| 10 | tappo / plug | ottone / brass |
| 11 | diffusore / diffuser | ottone / brass |
| 12 | terminale / end part | zama / zama |
| 13 | o-ring | NBR |
| 14 | elemento di fissaggio / fixing part | zama / zama |

DIMENSIONI / DIMENSIONS

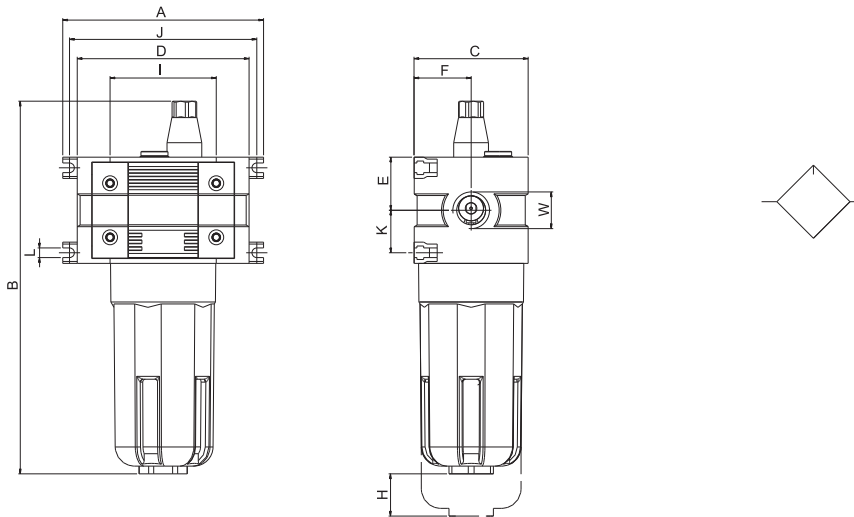

| | A | B | C | D | W | E | F | H | I | J | K | L | M | O | P |
|-------------------|-----|-----|----|------|-----------------|------|------|----|----|------|------|----|----|------|----|
| taglia 1 / size 1 | 72 | 162 | 45 | 75,5 | 1/8 - 1/4 - 3/8 | 21 | 22,5 | 39 | 43 | 18,5 | 26 | M4 | 29 | 18,5 | 55 |
| taglia 2 / size 2 | 89 | 195 | 59 | 89 | 1/4 - 3/8 - 1/2 | 27,5 | 28,5 | 48 | 55 | 69 | 32,5 | M5 | 29 | 62,5 | 69 |
| taglia 3 / size 3 | 100 | 214 | 70 | 106 | 1/2 - 3/4 - 1 | 32,5 | 35 | 50 | 65 | 79 | 38 | M6 | 29 | 73,5 | 80 |

SCHEMI ELETTRICI CARICAMENTO MANUALE OLIO A DUE LIVELLI / ELECTRICAL DATA OIL LOADING SYSTEM TWO STEPS SENSOR MANUAL

Lunghezza cavo / Cable length: 1500 mm

Corrente / Current: 0.5 A

Tensione / Voltage: <24V

Potenziale / Capacity: 10W

segnale al livello minimo
minimum level

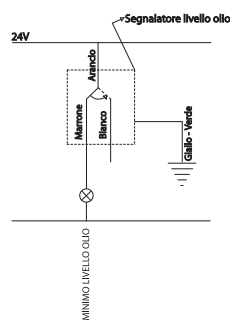

segnale al livello massimo
maximum level

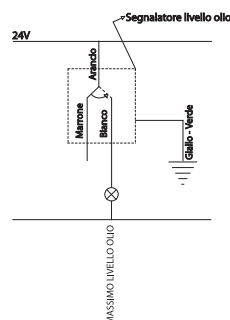

segnale livello olio al minimo e
al massimo
minimum and maximum level oil

