

The solenoid valves directly controlled are suitable for assembling on multiple or single bases; they have a low consumption of energy and have a small monostable control for an eventual manual intervention.

**L'électropilote à commande directe est particulièrement indiqué pour des montages sur embase multiple ou simple. Il a une faible consommation d'énergie et a une commande manuelle pour d'éventuelles interventions.**

*Gli elettropiloti a comando diretto sono particolarmente indicati per montaggio su basi multiple oppure su basi singole, permettono un basso assorbimento di energia ed hanno un piccolo comando monostabile per intervento manuale.*

**TECHNICAL DATA / DONNÉES TECHNIQUES / DATI TECNICI**

Type / <b>Type</b> / <i>Tipo</i>	3/2 NC
Max operating pressure / <b>Pression max d'utilisation</b> / <i>Pressione massima di esercizio</i>	0 - 7 bar
Max working temperature / <b>Température max d'utilisation</b> / <i>Temperatura max di esercizio</i>	-10°C / + 50°C
Flow rate to 6 bar and Δp 1 bar / <b>Débit à 6 bar et Δp 1 bar</b> / <i>Portata a 6 bar e Δp 1 bar</i>	15 Nl/min
Nominal orifice / <b>Diamètre nominal</b> / <i>Diametro nominale</i>	0,8 mm
Life time / <b>Durée</b> / <i>Durata cicli</i>	>50 millions cycles / >50 millions de cycles / >50 milioni di cicli
Tension tolerance / <b>Tolérance de tension</b> / <i>Tolleranza di tensione</i>	-10% - + 10%
Response time / <b>Temps de réponse</b> / <i>Tempo di risposta</i>	6ms (ON) - 8ms (OFF)
Duty cycle / <b>Temps d'enclenchement</b> / <i>Inserimento</i>	ED 100%
Voltage / <b>Voltage</b> / <i>Voltaggio</i>	12-24 VDC
Rated power consumption / <b>Consommation</b> / <i>Consumo a regime</i>	1.3 W
Protection / <b>Protection</b> / <i>Protezione</i>	IP 51

**FUNCTIONAL SCHEMATIC AND INSTALLATION / SCHÉMA FONCTIONNEMENT ET MONTAGE / SCHEMA FUNZIONAMENTO E INSTALLAZIONE**

Functional schematic  
**Schéma de fonctionnement**  
*Schema funzionamento*

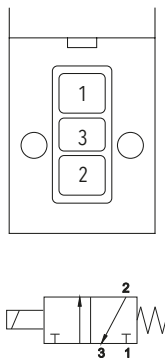

Sub-base installation  
**Installation embase**  
*Installazione sottobase*

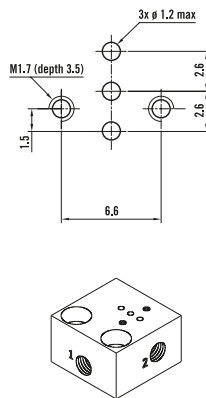

Valve installation  
**Installation de vanne**  
*Installazione della valvola*

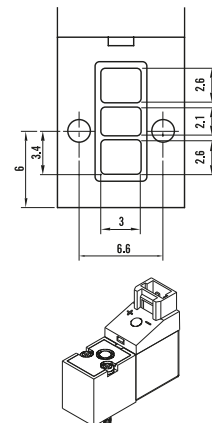

**CONNECTION ROTATION / CONNEXION ROTATION / ROTAZIONE CONNESSIONE**

With a simple click, it is possible to rotate the connection by 90° or 180° thus facilitating the laying of the power supply cable.

**Avec un simple clic, il est possible de faire pivoter la connexion de 90° ou 180° facilitant ainsi la pose du câble d'alimentation.**

*Con un semplice click, è possibile ruotare la connessione di 90° o 180° facilitando così la stesura del cavo di alimentazione elettrica.*

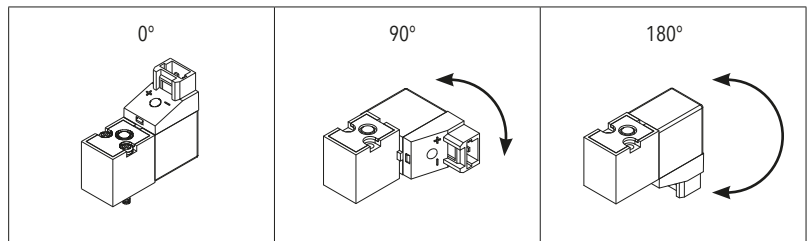

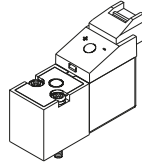
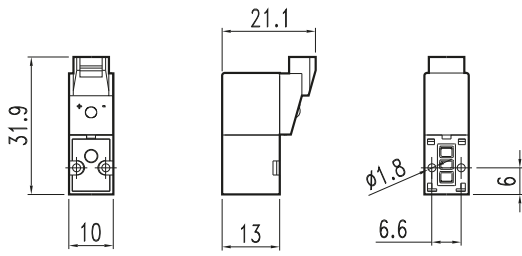

3/2 NC LOWER CONNECTOR  
**3/2 NF CONNECTEUR INFÉRIEUR**  
 3/2 NC CONNETTORE INFERIORE

CODE  
 EP50221 24V DC

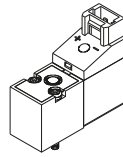
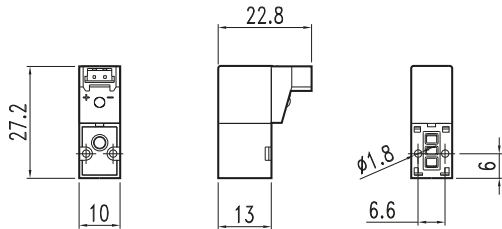
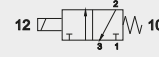

3/2 NC LATERALE CONNECTOR  
**3/2 NF CONNECTEUR LATÉRAL**  
 3/2 NC CONNETTORE LATÉRALE

CODE  
 EP50220 24V DC

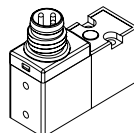
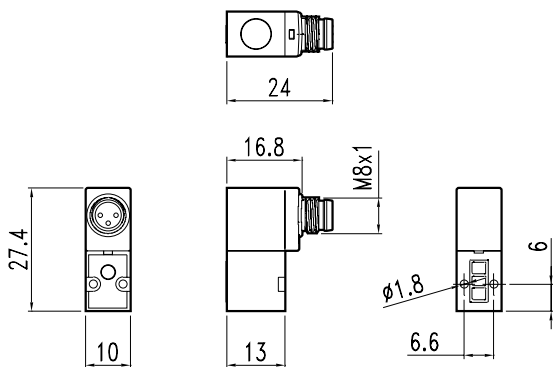
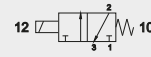

3/2 NC WITH M8 CONNECTOR  
**3/2 NF AVEC CONNECTEUR M8**  
 3/2 NC CON CONNETTORE M8

CODE  
 EP50223 24V DC

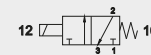

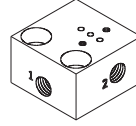
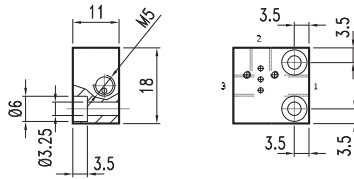

SINGLE MANIFOLD  
**EMBASE SIMPLE**  
 BASE SINGOLA

CODE  
**SB4010101**

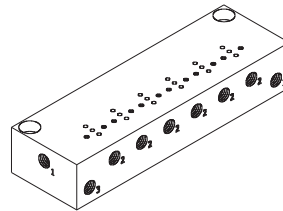
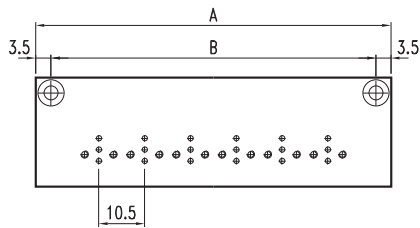
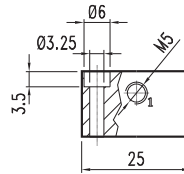
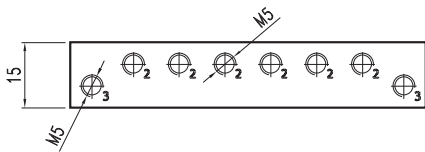

MANIFOLD  
**EMBASE MULTIPLE**  
 BASE MULTIPLA

CODE	POS.	A	B
SB4010102	2	39.5	32.5
SB4010103	3	50	43
SB4010104	4	60.5	53.5
SB4010105	5	71	64
SB4010106	6	81.5	74.5
SB4010107	7	92	85
SB4010108	8	102.5	95.5
SB4010109	9	113	106
SB4010110	10	123.5	116.5

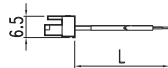
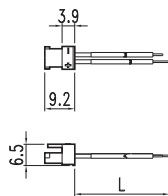

L = 300 mm  
 L = 500 mm  
 L = 1000 mm

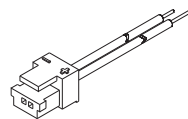

CONNECTORS  
**CONNECTEUR**  
 CONNETTORI

CODE	Length
VX0048	300mm
VX0049	500mm
VX0050	1000mm

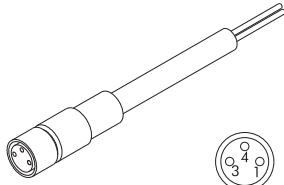

4= black / **noire** / *nero*  
 1= brown / **brun** / *marrone*  
 3= blue / **bleu** / *azzurro*

CONNECTOR M8 WITH CABLE 2,5 mt  
**CONNECTEUR M8 AVEC CABLES 2,5 mt**  
 CONNETTORE M8 CON CAVO 2,5 mt

**CODE**

**AR4301** 3 WIRES / 3 CÂBLES / 3 FILI

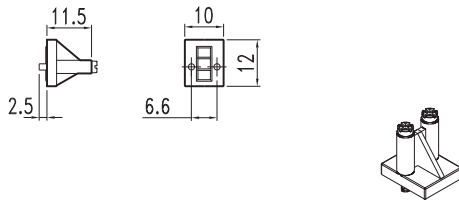

BLANKING PLATE  
**PLAQUE DE FERMETURE**  
 PIASTRINA DI CHIUSURA

**CODE**

**SB4010114**